



SVS SATELLITE SYSTEMS



SPF 180 C-KU BAND ANTENNA



- Designed for Ku, C, band uplink
- Easy to mount
- Simultaneously 3-axis movement
- Pointing to a Satellite with One Touch of a button
- Closing the Antenna with One Touch of a button
- Motor Current Protection and Software/Hardware limits
- Antenna Open Alarm Output for Safety
- Gps Data for modems
- Can be adapted for custom implementations
- Reflector lock for Heavy Applications (shock absorber)
- DVB Tuner Card for fine tuning and recognizing Satellite
- Robust Mechanic with Cogwheel Rigidity

SVS offers a complete line of Mobile Antennas, Quick Deploy Drive-Away Antennas at the best possible price. Designed with the latest technology to meet and exceed industry standards, SVS' Antenna Systems, Software and Antenna Controllers offer world-leading performance and unmatched quality. SVS' Drive-Away Antennas are easy to operate and ready to install in most vehicles. Includes auto-pointing AKS Controller and proven reliability

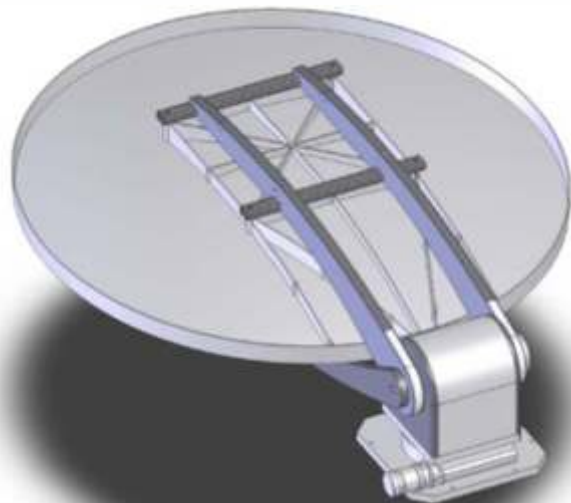

ANTENNA OPTIONS

- DE-ICING OPTION UP TO 2500 W
- FULL HOUSING OPTION
- 3 PORT FEED OPTION
- AKS SPECTRUM WIEVER OPTION
- W/G CROSSOVER KIT UNTIL FEED ARM
- 7/24 REMOTE SUPPORT SERVICE OPTION
- ON SITE PREVENTATIVE MAINTENANCE SERVICE OPTION
- ON SITE COMMISSIONING SERVICE OPTION
- SINGLE OR REDUNDANT AMPLIFIER INTEGRATION OPTION

SPF 180 C-KU BAND ANTENNA

RF SPECIFICATIONS	Transmit	Recive
Frequency Band	13.75-14.5 Ghz	10.95-12.75 GHz
Polarization	Linear Orthogonal	Linear Orthogonal
Antenna Gain	47 dBi@14.3 GHZ	45.5 dBi @ 12 GHZ
Antenna Noise Temperature	-	48°K el; 10°
3 dB Beamwidth	0.8° @ 14.3 GHz	1.0° @ 12.0 GHz
Antenna Cross Polarization Isolation	32 dB ; 37 dB in .5 dB Contour	32 dB ; 37 dB in .5 dB Contour
Copolar Sidelobe Envelope	2.5° <θ < 7° 29-25log θ	-
	7° <θ < 9.2 8 dBi	-
	9.2° < θ < 48° 32-25log θ	-
	48° <θ < 180° -10dBi	-
VSWR	1:3:1	1:5:1
Feed Interface	WR-75	WR-75
Isolation	80 dB	40 dB
Insertion Loss	0.2 dB	0.3 dB
MECHANICAL SPECIFICATIONS		
Antenna Geometry	Offset Gregorian (Dual Optics)	
Ports	2 (optionally 3)	
Elevation Range	10°-90°	
Azimuth Range	±180	
Polarization Range	±100°	
Weight	150 Kg	
Reflector Material	Glass Fiber Reinforced Polyester	
SPEED	Minimum	Maximum
Elevation	0.2 °/sec	1.6 °/sec
Azimuth	0.2 °/sec	1.6 °/sec
Polarization	0.65 °/sec	13 °/sec
ENVIRONMENTAL SPECIFICATION	Operational	Survival
Wind Load	72km/h	120 km/h(stowed)
Ambient Temperature	-30°C to.+ 60°C	-50°C to 80°C
Humidity	%0 - %100	%0 - %100